

MOVE - IN SCHEDULE

- Monday, October 30th - 11:00AM
- Monday, October 30th - 1:00PM
- Monday, October 30th - 3:00PM
- Tuesday, October 31st - 8:00AM
- Tuesday, October 31st - 12:00PM (noon)
- Wednesday, November 1st - 8:00AM
- Wednesday, November 1st - 12:00PM (noon) - LIFO

DERRY ROAD



Woodworking Machinery & Supply
Conference and Expo

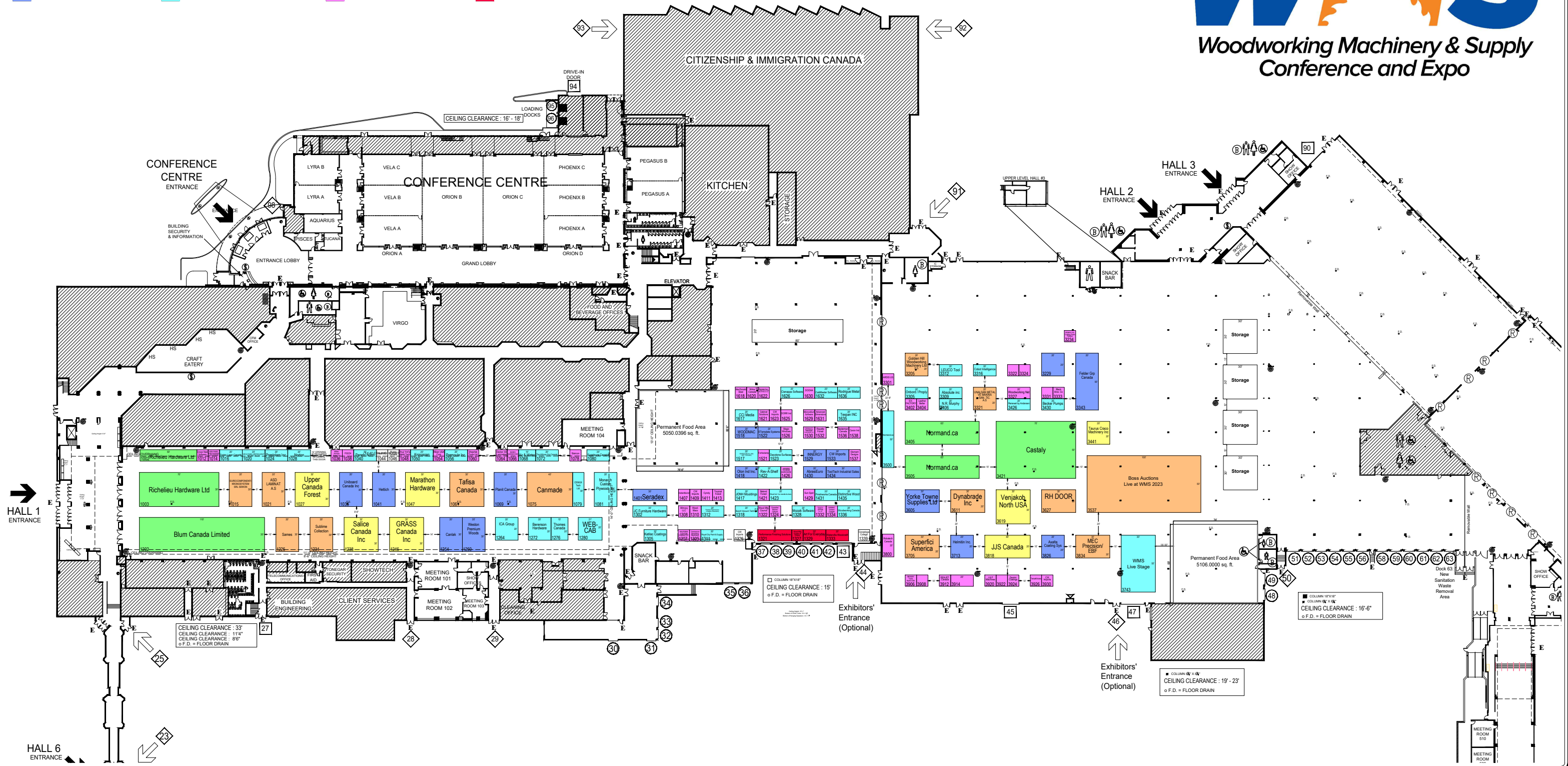

COPYRIGHT © 2010 Global Experience Specialists.

All Rights Reserved. No part of this publication may be reproduced, stored in any retrieval system, or transmitted in any form or by any means - electronic, mechanical, photocopying, recording, or otherwise - without the express written consent of Global Experience Specialists

Every effort has been made to insure the accuracy of all information contained on this floor plan. However, no warranties, either expressed or implied, are made with respect to this floor plan. If the location of building columns, utilities, or other architectural components of the facility is a consideration in the construction or usage of an exhibit, it is the sole responsibility of the exhibitor to physically inspect the facility to verify all dimensions and locations.

Inventory as of 10/06/2023

Dimension	Size	Qty	SqFt	Rented	Available
10x10	100	62	6,200	57	5
10x15	150	1	1,500	1	0
10x20	200	45	9,000	44	1
10x30	300	5	9,000	5	0
15x20	300	1	3,000	1	0
20x20	400	4	8,000	4	0
20x21	420	1	4,200	1	0
10x50	500	2	10,000	2	0
20x30	600	15	9,000	15	0
20x40	800	1	8,000	1	0
30x30	900	6	8,100	6	0
20x60	1,000	1	10,000	1	0
30x60	1,200	1	14,400	1	0
20x60	1,300	2	2,600	2	0
30x60	1,800	1	1,800	1	0
30x70	2,100	1	2,100	1	0
30x100	3,000	1	3,000	1	0
50x70	3,500	1	3,500	1	0
50x100	5,000	1	5,000	0	1
Total:		156	57,170	147	9

November 2-4, 2023
The International Centre
Exhibit Halls 1 & 2

Confidential Property Of
Global Experience Specialists

File: WMS23 Oct 06 23.dwg
Layout: Move In
Plotted: October 17, 2023, 8:12:30 PM
By: Nasera Pirbhai