

Seattle Auto Show Move-in Routes

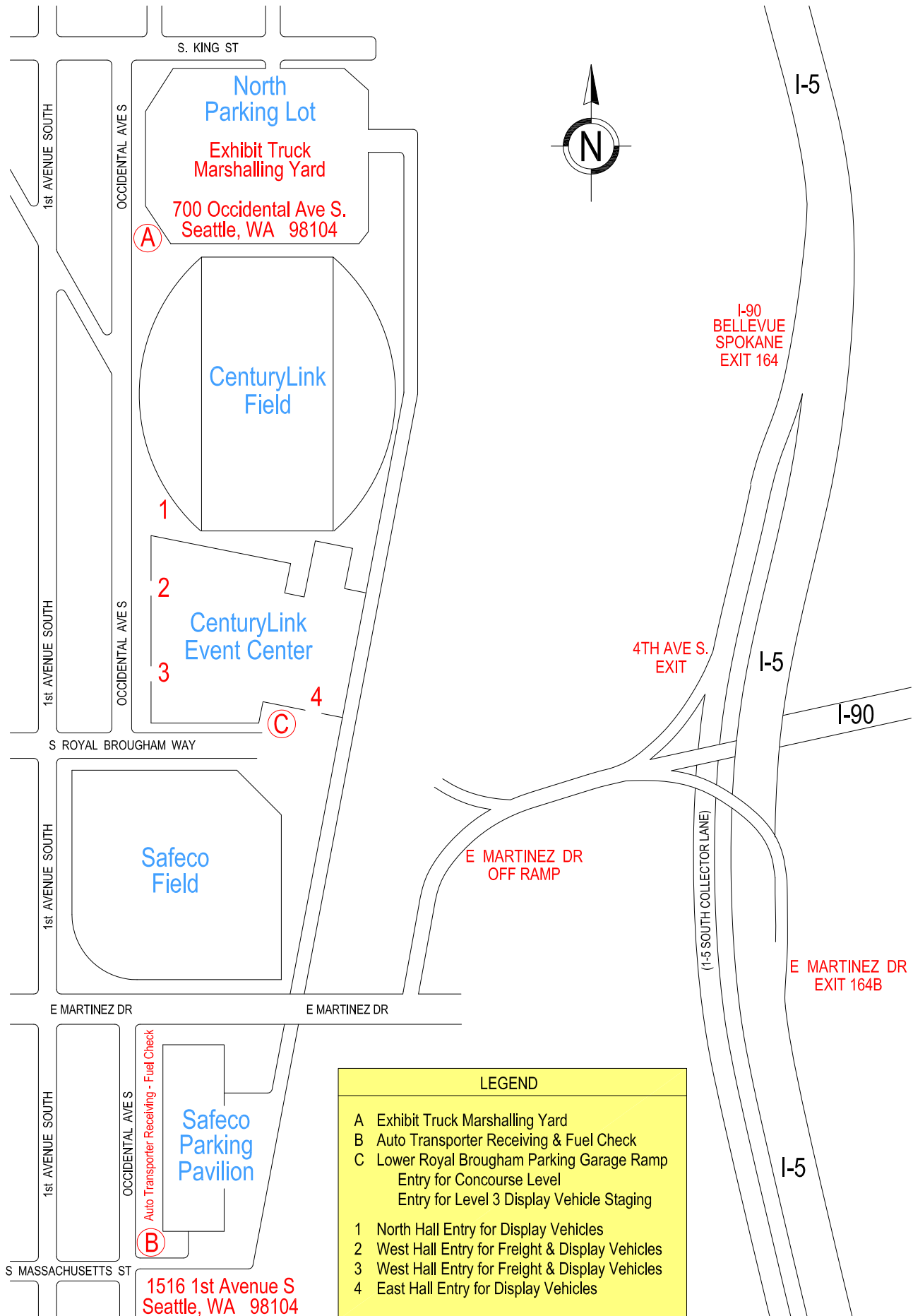

LEGEND	
A	Exhibit Truck Marshalling Yard
B	Auto Transporter Receiving & Fuel Check
C	Lower Royal Brougham Parking Garage Ramp
	Entry for Concourse Level
	Entry for Level 3 Display Vehicle Staging
1	North Hall Entry for Display Vehicles
2	West Hall Entry for Freight & Display Vehicles
3	West Hall Entry for Freight & Display Vehicles
4	East Hall Entry for Display Vehicles

Exhibit Truck Marshalling Yard

Address: 700 Occidental Ave S.
Seattle, WA 98104

Directions:

North Bound I-5

Take the E Martinez Dr Exit 164B E Martinez Dr. At E Martinez Dr. light, turn right (no free right on red). At the 1st Ave S light, turn right go one block to S. Royal Brougham Way. Turn right onto S Royal Brougham Way and get into the left turn lane. At the light, turn left on to Occidental Ave S. Head north on Occidental, entrance to the North Parking Lot Marshalling Yard will be on the right (east) side of the street, just past the football stadium.

South Bound I-5

I-5 will split off a collector/distributor lane for the I-90 interchange; follow signs for I-90 Bellevue/Spokane exit 164. After the split, move to the right lane and follow signs for 4th Ave S. After exiting the collector/distributor lane towards 4th Ave S., exit to the left for E Martinez Dr. At E Martinez Dr. light, turn right (no free right on red). At the 1st Ave S light, turn right go one block to S. Royal Brougham Way. Turn right onto S Royal Brougham Way and get into the left turn lane. At the light, turn left on to Occidental Ave S. Head north on Occidental, entrance to the North Parking Lot Marshalling Yard will be on the right (east) side of the street, just past the football stadium.

West Bound I-90

Follow signs for 4th Ave S. From the 4th Ave S collector/distributor lane, exit to the left for E Martinez Dr. At E Martinez Dr. light, turn right (no free right on red). At the 1st Ave S light, turn right go one block to S. Royal Brougham Way. Turn right onto S Royal Brougham Way and get into the left turn lane. At the light, turn left on to Occidental Ave S. Head north on Occidental, entrance to the North Parking Lot Marshalling Yard will be on the right (east) side of the street, just past the football stadium.