

In-Bound Targets

- Marshalling Yard Check-In:
6:30 AM - 12:00 NOON
Saturday, March 14, 2020
Approximate Unload Time:
8:00 AM - 5:00 PM
- Marshalling Yard Check-In:
6:30 AM - 10:00 AM
Sunday, March 15, 2020
Approximate Unload Time:
8:00 AM - 2:00 PM
- Marshalling Yard Check-In:
6:30 AM - 2:00 PM
Monday, March 16, 2020
Approximate Unload Time:
8:00 AM - 5:00 PM
- Marshalling Yard Check-In:
6:30 AM - 2:30 PM
Tuesday, March 17, 2020
Approximate Unload Time:
8:00 AM - 5:00 PM

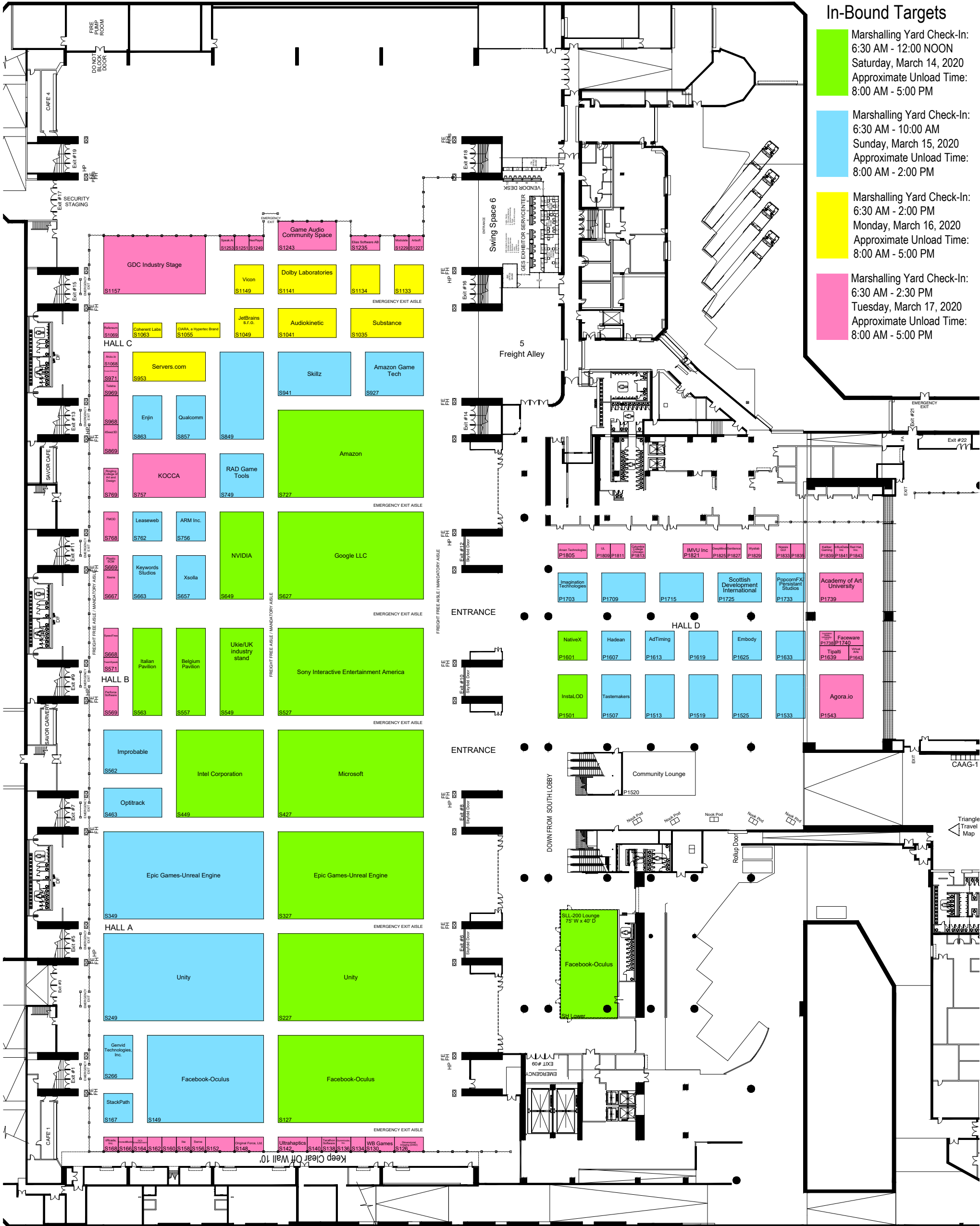

In-Bound Targets

Marshalling Yard Check-In:
6:30 AM - 12:00 NOON
Saturday, March 14, 2020
Approximate Unload Time:
8:00 AM - 5:00 PM

Marshalling Yard Check-In:
6:30 AM - 10:00 AM
Sunday, March 15, 2020
Approximate Unload Time:
8:00 AM - 2:00 PM

Marshalling Yard Check-In:
6:30 AM - 2:00 PM
Monday, March 16, 2020
Approximate Unload Time:
8:00 AM - 5:00 PM

SPECIFIC TIMES CANNOT BE DETERMINED OR GUARANTEED
AS TO WHEN YOUR CARRIER WILL BE DISPATCHED
TO THE EXHIBIT HALL AND UNLOADED
ALL CRATES MUST BE OFF THE SHOW FLOOR BY

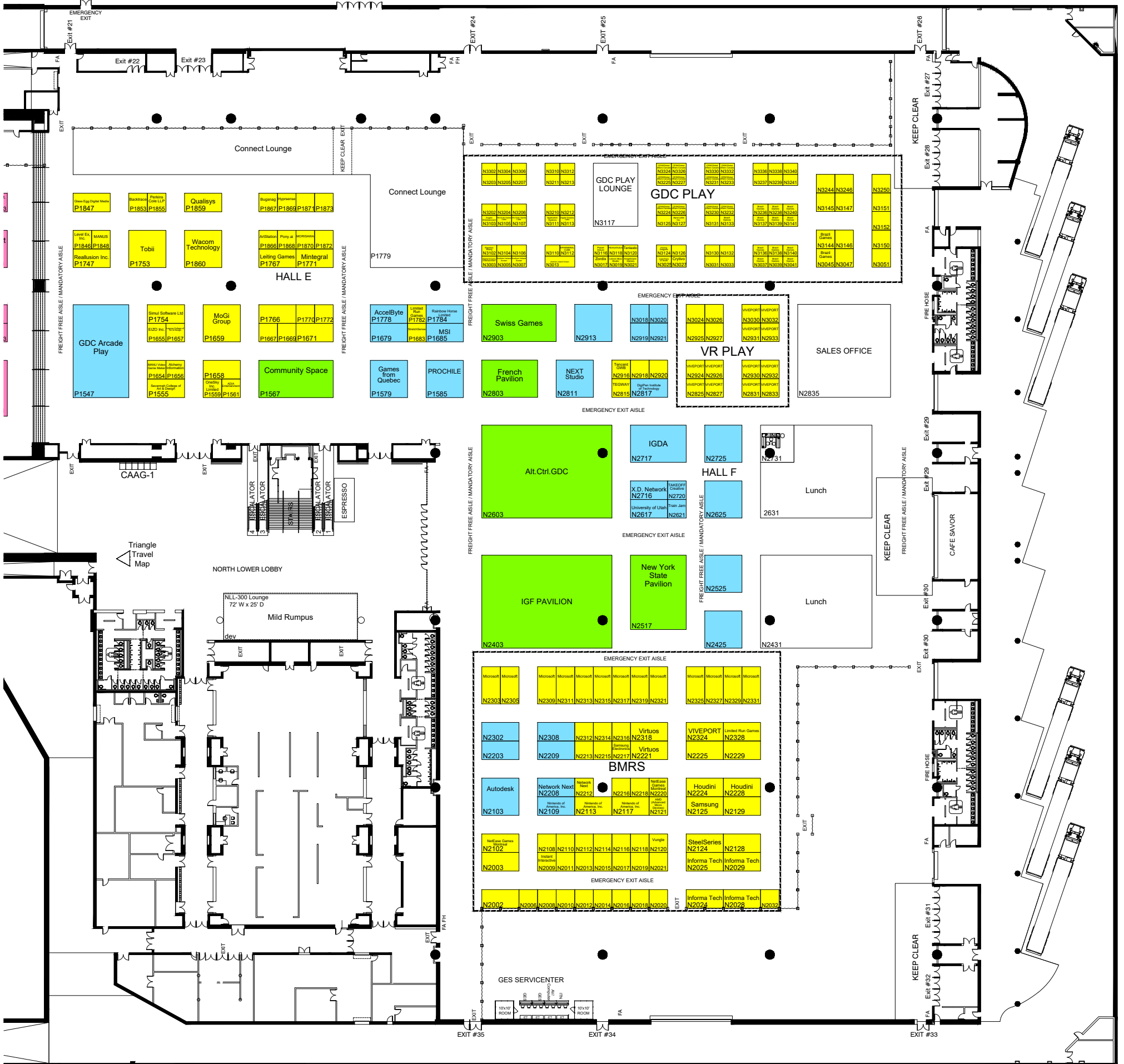

Game Developers Conference 2020
March 18-20, 2020
Moscone Center - Halls EF

EVERY EFFORT HAS BEEN MADE TO INSURE THE ACCURACY OF ALL INFORMATION CONTAINED ON THIS FLOOR PLAN. HOWEVER, NO WARRANTIES, EITHER EXPRESSED OR IMPLIED, ARE MADE WITH RESPECT TO THE FLOOR PLAN. IF THE LOCATION OF BUILDING COLUMN, UTILITIES OR OTHER ARCHITECTURAL COMPONENTS OF THE FACILITY IS A CONSIDERATION IN THE CONSTRUCTION OR USAGE OF AN EXHIBIT, IT IS THE SOLE RESPONSIBILITY OF THE EXHIBITOR TO PHYSICALLY INSPECT THE FACILITY TO VERIFY ALL DIMENSIONS AND LOCATIONS.

COPYRIGHT © BY GLOBAL EXPERIENCE SPECIALISTS. ALL RIGHTS RESERVED. NO PART OF THIS PUBLICATION MAY BE REPRODUCED, STORED IN ANY RETRIEVAL SYSTEM, OR TRANSMITTED IN ANY FORM OR BY ANY MEANS, ELECTRONIC, MECHANICAL, PHOTOCOPIING, RECORDING, OR OTHERWISE, WITHOUT EXPRESS WRITTEN CONSENT OF GLOBAL EXPERIENCE SPECIALISTS.



File: cgdc-2003-moscon.dwg
Plotted: Jan 07, 2020
By: MCDERD