

Inventory as of 03/26/2024

11,637 SqFt Rented
100 SqFt Available

Dimension	Size	Qty	SqFt	Rented	Available
10'x10'	100	17	1,700	16	1
10'x20'	200	10	2,000	10	0
20'x20'	400	5	2,000	5	0
20'x30'	600	2	1,200	2	0
25'x29'	725	1	725	1	0
20'x40'	800	1	800	1	0
28'x29'	812	1	812	1	0
50'x50'	2,500	1	2,500	1	0
Totals:		38	11,737	37	1

In-Bound Target

- Friday, April 5 @ 9:00 am
- Saturday, April 6 @ 9:00 am

Empties Returned By:
While GES will BEGIN returning empties at the conclusion of the trade show on Thursday, all respective returns will be completed by the targeted time noted below.

- Thursday, April 11 @ 1:00 pm
- Thursday, April 11 @ 6:00 pm
- Thursday, April 11 @ 10:00 pm

- Out-Bound Target**
Below is the deadline when freight must be packed, labeled, bill of lading turned in and carrier ready to load.
- Thursday, April 11 @ 2:00 pm
 - Thursday, April 11 @ 9:00 pm
 - Friday, April 12 @ 8:00 am

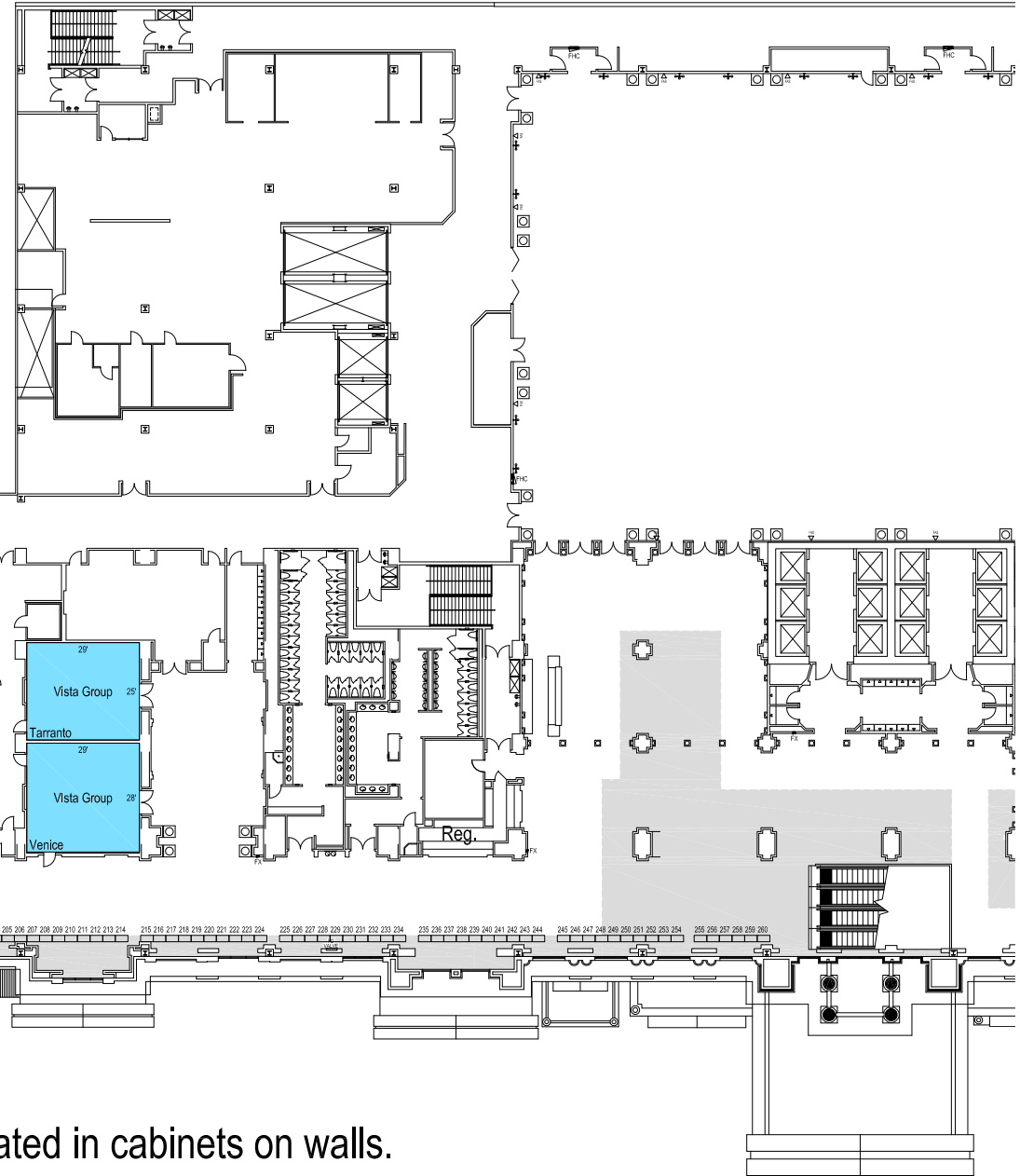

Note: Electrical is located in cabinets on walls.