

Inventory as of 01/20/2017

| Dimension | Size | Qty | SqFt | Rented | Available |
|----------------|-------|-----------|---------------|-----------|-----------|
| 26'-9"x28'-10" | 771 | 1 | 771 | 0 | 1 |
| 27'-9"x46' | 1,277 | 1 | 1,277 | 0 | 1 |
| 29'-4"x46' | 1,349 | 1 | 1,349 | 0 | 1 |
| 31'x46' | 1,426 | 2 | 2,852 | 0 | 2 |
| 34'-11"x41'-8" | 1,455 | 1 | 1,455 | 1 | 0 |
| 36'-2"x41'-8" | 1,507 | 2 | 3,014 | 2 | 0 |
| 34'-11"x56'-4" | 1,966 | 2 | 3,931 | 2 | 0 |
| 41'-8"x48'-9" | 2,031 | 1 | 2,031 | 1 | 0 |
| 36'-2"x56'-4" | 2,035 | 3 | 6,105 | 3 | 0 |
| 35'-1"x58'-6" | 2,050 | 2 | 4,100 | 2 | 0 |
| Totals: | | 16 | 26,885 | 11 | 5 |

In-Bound Target

Saturday, March 25, 2017 at 8:00 am

Empties Returned By:

While GES will BEGIN returning empties at the conclusion of the trade show on Thursday, all respective returns will be completed by the targeted time noted below.

Thursday, March 30, 2017 at 8:00 pm

Out-Bound Target

Below is the deadline when freight must be packed, labeled, bill of lading turned in and carrier ready to load.

Friday, March 31, 2017 at 9:00 am

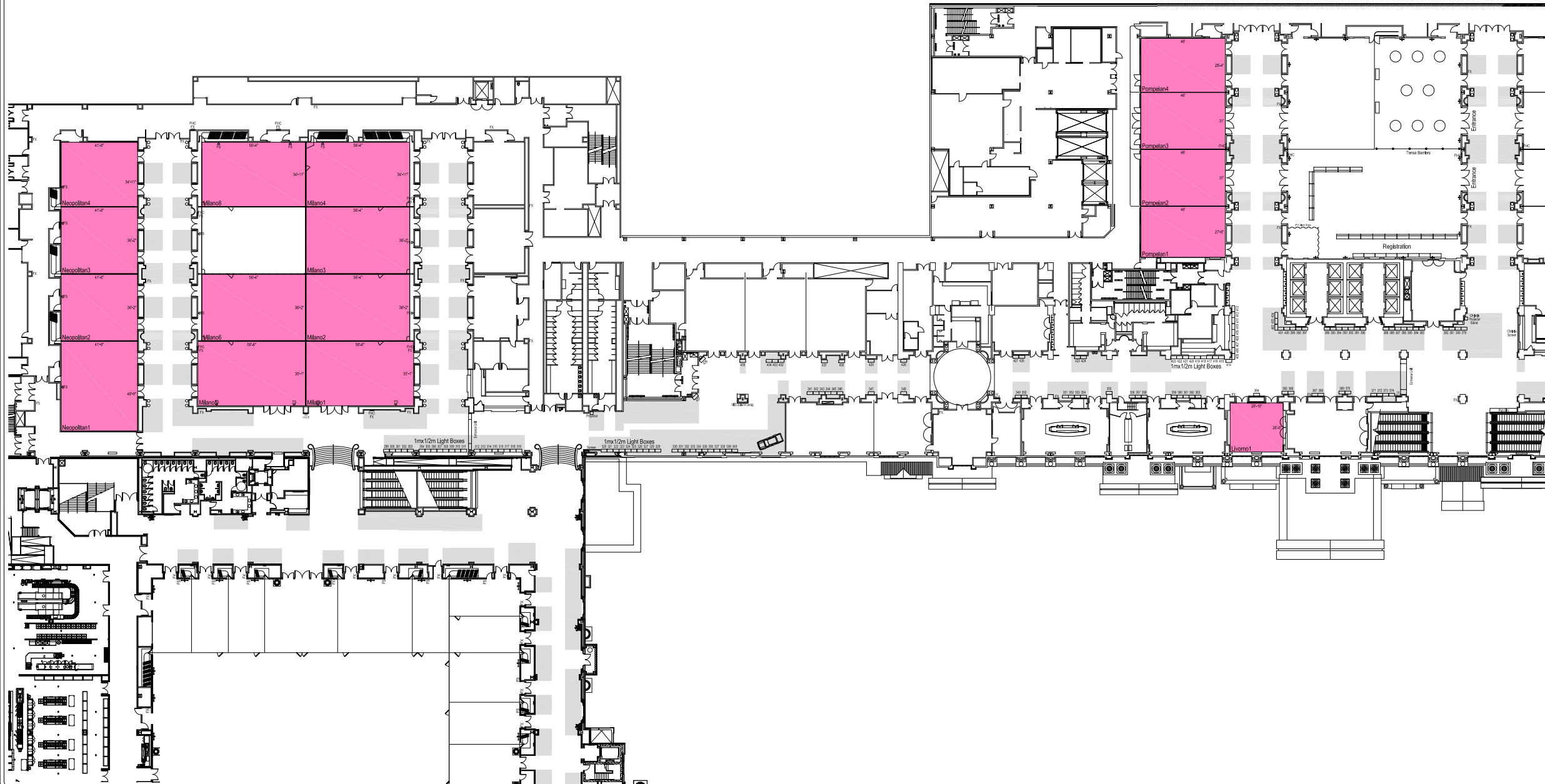

GES Global Experience Specialists

COPYRIGHT © BY GLOBAL EXPERIENCE SPECIALISTS. ALL RIGHTS RESERVED. NO PART OF THIS PUBLICATION MAY BE REPRODUCED, STORED IN ANY RETRIEVAL SYSTEM, OR TRANSMITTED IN ANY FORM OR BY ANY MEANS - ELECTRONIC, MECHANICAL, PHOTOCOPIING, RECORDING, OR OTHERWISE - WITHOUT EXPRESS WRITTEN CONSENT OF GLOBAL EXPERIENCE SPECIALISTS.

CinemaCon
 March 28 - 30, 2017
 Caesar's Palace - Promenade Level

CONFIDENTIAL PROPERTY OF GES
 File: nato-1703-cp - i3.dwg
 Plotted: Jan 20, 2017
 By: HATCHC

EVERY EFFORT HAS BEEN MADE TO INSURE THE ACCURACY OF ALL INFORMATION CONTAINED ON THIS FLOOR PLAN. HOWEVER, NO WARRANTIES, EITHER EXPRESSED OR IMPLIED, ARE MADE WITH RESPECT TO THIS FLOOR PLAN. IF THE LOCATION OF BUILDING COLUMNS, UTILITIES, OR OTHER ARCHITECTURAL COMPONENTS OF THE FACILITY IS A CONSIDERATION IN THE CONSTRUCTION OR USAGE OF AN EXHIBIT, IT IS THE SOLE RESPONSIBILITY OF THE EXHIBITOR TO PHYSICALLY INSPECT THE FACILITY TO VERIFY ALL DIMENSIONS AND LOCATIONS.