

PRE-ORDERED BOOTH PACKAGES

HARDWALL PACKAGE TECHNICALS 10X10 LINEAR BOOTH

Modifications & substitutions to the Hardwall Package are not allowed. Custom graphics, cleaning, vacuuming and additional electricity (if needed) is not included and can be ordered at the exhibitor's expense.

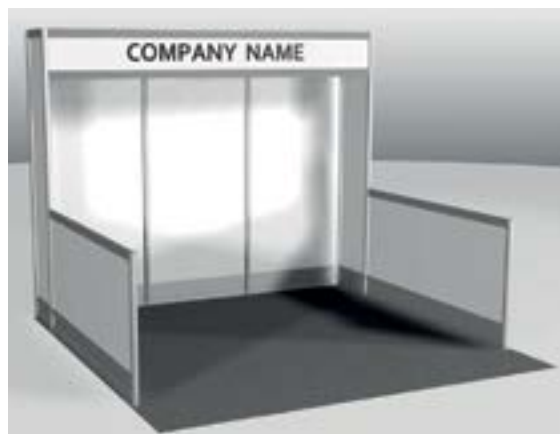

Qty	Type	Size	Visual Opening	Material	Color
3	Wall Panel (A)	38 ³ / ₁₆ "W x 86 ¹ / ₄ "H	37 ⁹ / ₁₆ "W x 85 ³ / ₈ "H	PVC	White
2	Wall Panel (B)	77 ⁹ / ₁₆ "W x 30 ¹ / ₄ "H	76 ¹⁵ / ₁₆ "W x 29 ⁵ / ₁₆ "H	PVC	White
1	ID Sign (C)	116 ¹⁵ / ₁₆ "W x 12"H	116 ⁵ / ₁₆ "W x 11 ¹ / ₈ "H	PVC	White
2	Wall Panel (D)	18 ¹ / ₂ "W x 86 ¹ / ₄ "H	17 ⁷ / ₈ "W x 8 ³ / ₈ "H	PVC	White
1	Wastebasket (300113)				
1	Carpet				Gray

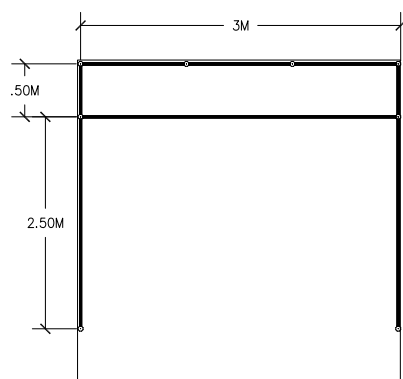

PLAN VIEW

CHOOSING TO HANG YOUR OWN GRAPHICS?

NOTE: Booth packages are the property of GES. All graphics & hanging materials used to affix them must be completely removed from walls and furnishings upon departure in order to avoid cleaning fees.

FOR MORE INFORMATION ABOUT THIS BOOTH PACKAGE

Including payment, graphics, package options and/or upgrades, please contact:

GES National Servicercenter

Phone: 702-515-5970

Toll Free: 800-475-2098

FAX Domestic: 866-329-1437

FAX International: 702-263-1520

WWW.GES.COM/CHAT

The description above is based on the 10' x 10' booth package. As booth size increases, booth package items/contents are multiplied accordingly.

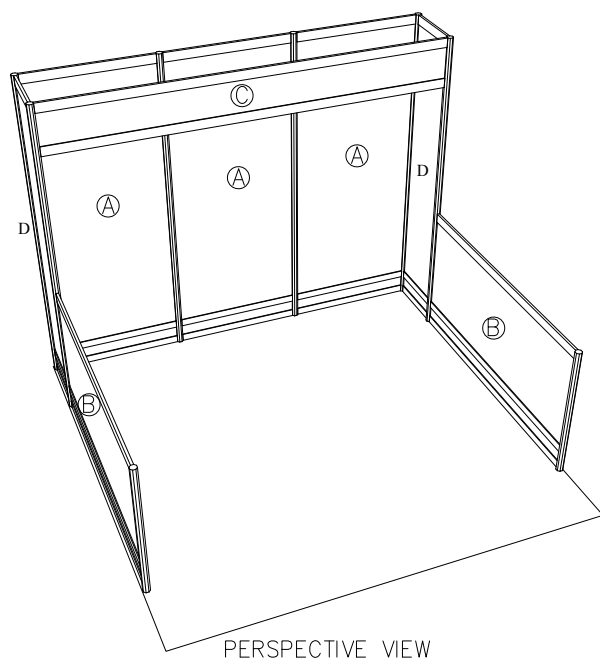

PERSPECTIVE VIEW

PRE-ORDERED BOOTH PACKAGES

HARDWALL PACKAGE TECHNICALS 10X15 LINEAR BOOTH

Modifications & substitutions to the Hardwall Package are not allowed. Custom graphics, cleaning, vacuuming and additional electricity (if needed) is not included and can be ordered at the exhibitor's expense.



Qty	Type	Size	Visual Opening	Material	Color
4	Wall Panel (A)	38 ³ / ₁₆ "W x 86 ¹ / ₄ "H	37 ⁹ / ₁₆ "W x 85 ³ / ₈ "H	PVC	White
2	Wall Panel (B)	77 ⁹ / ₁₆ "W x 30 ¹ / ₄ "H	76 ¹⁵ / ₁₆ "W x 29 ⁵ / ₁₆ "H	PVC	White
1	ID Sign (C)	176"W x 12"H		PVC	White
3	Wall Panel (D)	18 ¹ / ₂ "W x 86 ¹ / ₄ "H	17 ⁷ / ₈ "W x 8 ³ / ₈ "H	PVC	White
1	Wastebasket (300113)				
1	Carpet				Gray

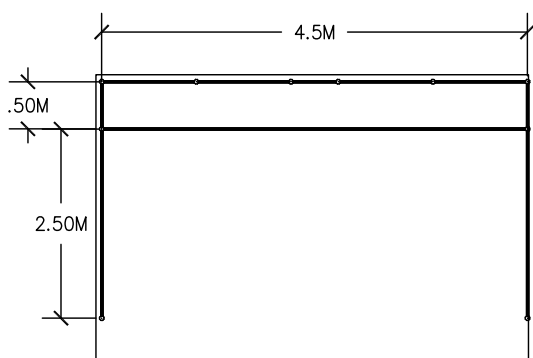

PLAN VIEW

CHOOSING TO HANG YOUR OWN GRAPHICS?

NOTE: Booth packages are the property of GES. All graphics & hanging materials used to affix them must be completely removed from walls and furnishings upon departure in order to avoid cleaning fees.

FOR MORE INFORMATION ABOUT THIS BOOTH PACKAGE

Including payment, graphics, package options and/or upgrades, please contact:

GES National Servicercenter

Phone: 702-515-5970

Toll Free: 800-475-2098

FAX Domestic: 866-329-1437

FAX International: 702-263-1520

WWW.GES.COM/CHAT

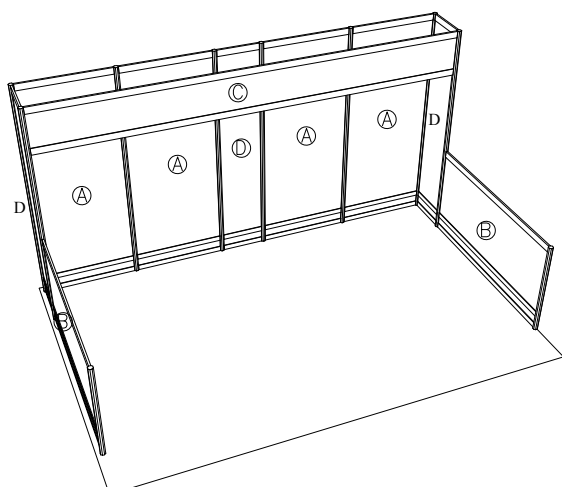

PERSPECTIVE VIEW

PRE-ORDERED BOOTH PACKAGES

HARDWALL PACKAGE TECHNICALS 10X20 LINEAR BOOTH

Modifications & substitutions to the Hardwall Package are not allowed. Custom graphics, cleaning, vacuuming and additional electricity (if needed) is not included and can be ordered at the exhibitor's expense.



Qty	Type	Size	Visual Opening	Material	Color
6	Wall Panel (A)	38 ³ / ₁₆ "W x 86 ¹ / ₄ "H	37 ⁹ / ₁₆ "W x 85 ³ / ₈ "H	PVC	White
2	Wall Panel (B)	77 ⁹ / ₁₆ "W x 30 ¹ / ₄ "H	76 ¹⁵ / ₁₆ "W x 29 ⁵ / ₁₆ "H	PVC	White
1	ID Sign (C)	235"W x 12"H		PVC	White
2	Wall Panel (D)	18 ¹ / ₂ "W x 86 ¹ / ₄ "H	17 ⁷ / ₈ "W x 8 ³ / ₈ "H	PVC	White
1	Wastebasket (300113)				
1	Carpet				Gray

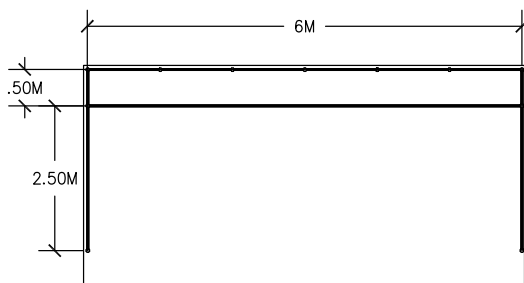

PLAN VIEW

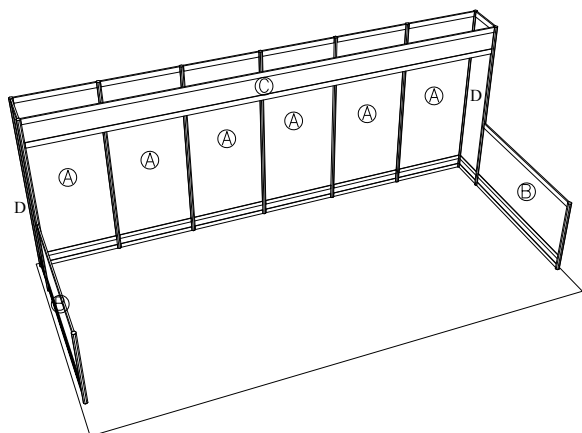

PERSPECTIVE VIEW

CHOOSING TO HANG YOUR OWN GRAPHICS?

NOTE: Booth packages are the property of GES. All graphics & hanging materials used to affix them must be completely removed from walls and furnishings upon departure in order to avoid cleaning fees.

FOR MORE INFORMATION ABOUT THIS BOOTH PACKAGE

Including payment, graphics, package options and/or upgrades, please contact:

GES National Servicercenter

Phone: 702-515-5970

Toll Free: 800-475-2098

FAX Domestic: 866-329-1437

FAX International: 702-263-1520

WWW.GES.COM/CHAT